

32896 KLI-3R

TH35 rail-mounted voltage detector

5905339328960

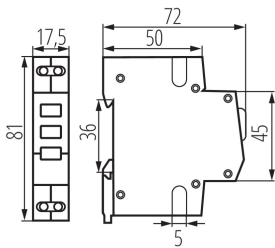

GENERAL DATA:

Colour: white

Place of assembly: rail TH35

Norm: PN-EN 60947-5-1

Length [mm]: 72

Width [mm]: 17.5

Height [mm]: 81

Number of fields: 1

TECHNICAL DATA:

Rated voltage [V]: 230 AC

Rated current [A]: 2.5

Rated frequency [Hz]: 50

Connection type: Terminal block

Range of sections of wires used [mm²]: max 2,5

Number of modules: 1

Power consumption [W]: 0.6

IP class: 20

LOGISTIC DATA:

Packaging method: 12

Number of units in the secondary packaging: 12

Number of units in the packaging: 120

Net unit weight [g]: 44

Grammage [g]: 52.42

Length of a unit pack [cm]: 7.5

Width of a unit pack [cm]: 2

Height of a unit pack [cm]: 8.5

Weight of a cardboard box [kg]: 6.2904

Width of a cardboard box [cm]: 24

Height of a cardboard box [cm]: 19.5

Length of a cardboard box [cm]: 46

Volume of a cardboard box [m³]: 0.021528